

An aerial photograph of a long, straight road, likely a highway or main thoroughfare, stretching horizontally across the frame. The road is flanked by various structures, including buildings, parking lots, and greenery. Yellow arrows are overlaid on the road surface, pointing in both directions to indicate traffic flow. Yellow lines are also overlaid, marking the boundaries of the road and possibly specific lanes or sections. The overall scene suggests a detailed analysis of road layout and traffic patterns.

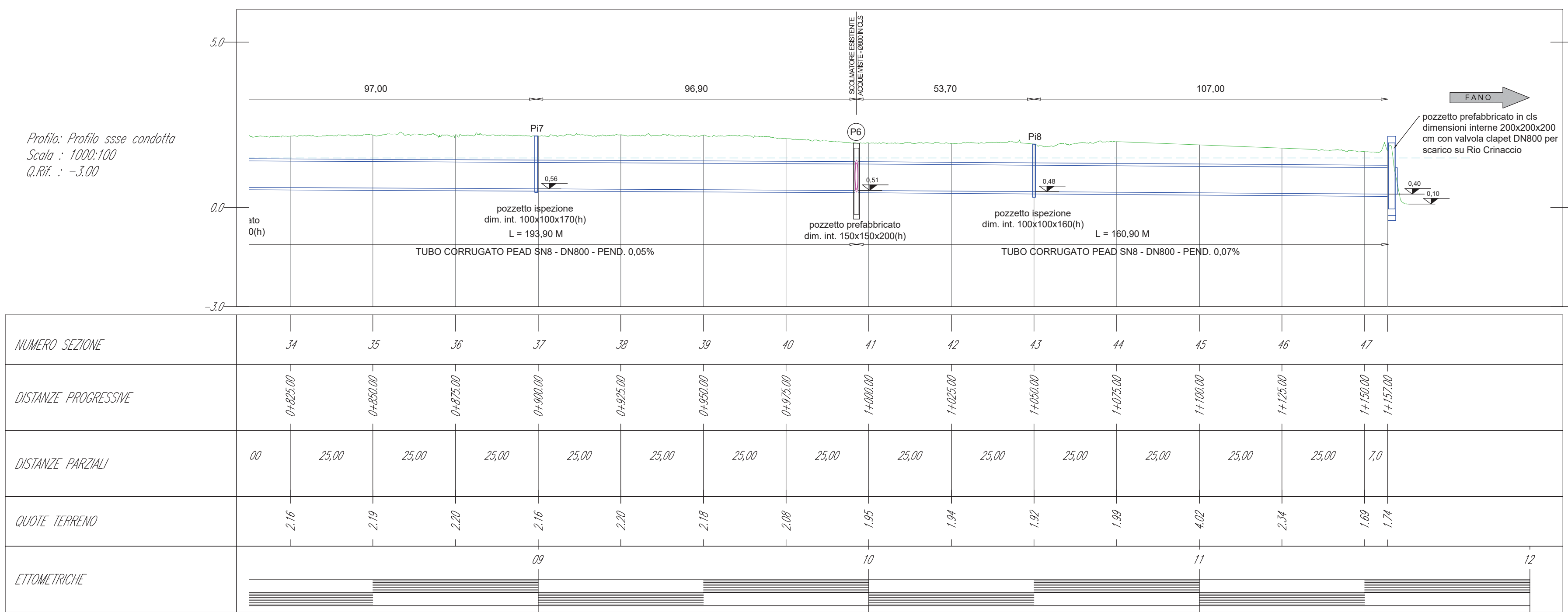

IN FASE DI SCAVI FARE ATTENZIONE ALLA CONDOTTA DELLA FOGNATURA MISTA PRESENTE LUNGO LA SEDE STRADALE PER I PRIMI 230 METRI DI INTERVENTO.

